



MODEL 44RMTFB - FUZIONATE PRESSURIZED SOFT SERVE FREEZER

FEATURES

The Fuzionate™ fully integrates flavor into every bite, producing smooth, creamy, and consistent soft serve, or frozen yogurt.

9 Flavor Options

Easily infuse and adjust flavor concentration with the press of a button from 32 oz syrup containers.

Patented Flavor Blending System

Completely blends the flavors into the product while maintaining high product quality and consistency.

Premium Frozen Product

Delivers smooth, creamy, and consistently premium-quality soft serve.

Versatile Menu

Perfect for ice cream, frozen yogurt, or limited time offers.

Flexible Mix Holding System

Pumps mix directly from bags or containers for seamless operation.

Patented Mix Transfer System

The simplest and most reliable pressurized system available.

Long Lasting Scraper Blades

Durable reversible scraper blades minimizes replacements while ensuring a smooth, consistent texture for premium-quality frozen treats.

Innovative Auger Technology

Gently blends for optimal texture and consistency.

Standby Mode

Reduces energy costs while maintaining safe product storage.



PERFECT FOR

- Co-Branding
- College Cafeterias
- Dessert Shops
- Buffets



44RMTFB





MODEL 44RMTFB SPECIFICATIONS

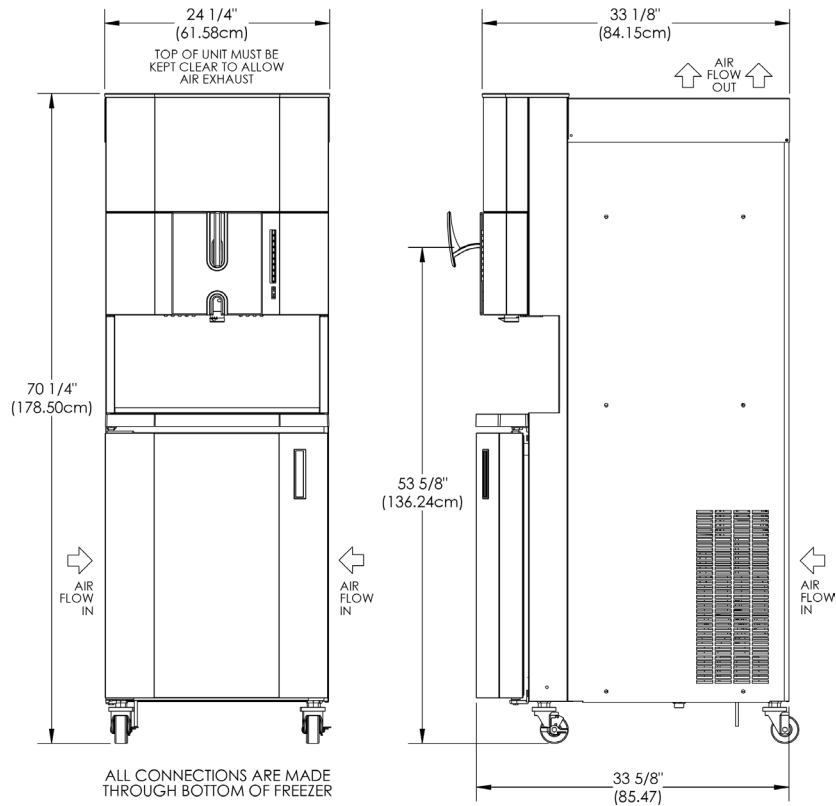

Weight

Net	710 lbs	322 kg
Crated	762 lbs	345.6 kg

Volume

58.42 cubic ft	1.65 cubic m
----------------	--------------

Dimensions

24-1/4" x 33-1/8" x 70-1/4"
61.58cm x 84.15cm x 178.5cm

Freezing Cylinder Capacity

One - 3.7 qts (3.5 liters) each

Potable Water Connection

3/8" FPT

Syrup Bottle Capacity

8 qty - 32 oz (.95 liters)

Refrigerant Types*

One, 6,700 Btuh
R404a R452a

Separate Cabinet Refrigerant

One, 1200 Btuh

Electrical

	Max Fuse Size	Min Circuit Ampacity	Poles (P) Wires(W)
208-230/60/3 Air	20	17.5	3P, 3W
209-230/60/3 Water	20	16	3P, 3W
208-230/60/1 Air	25	22	2P, 2W
209-230/60/1 Water	25	20.5	2P, 2W
Total Amps (qty)		kW	Poles (P) Wires(W)
380-415/50/3 Air	11.5	4.5	3P, 4W

Exterior Space Required

Water Cooled : 6" (7.6 cm) air space required on both sides or rear panel for circulation

Air Cooled : 6" (15.3 cm) air space required on both sides or rear panel for circulation

Certified and/or listed by:



*UL listed and listed by Underwriters Laboratories under Canadian National Standard C22.2 No. 120-13

*Customer is responsible for complying with local refrigeration regulations.



DISTRIBUTOR



LOCATOR